

Formerly Edward Halferty
now Robert Halferty

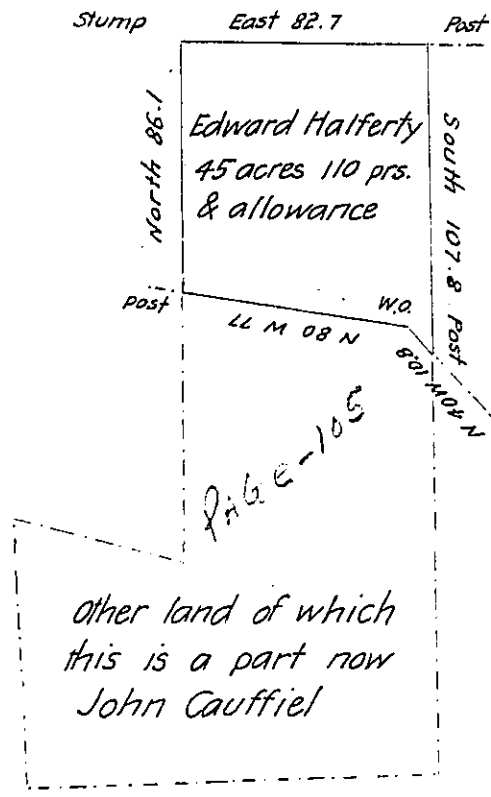

Formerly Cornelius Clawson
now Robert Halferty

A draught of part of a tract of land which was surveyed in pursuance of a Warrant granted to Edward Halferty dated March 11th 1816 containing forty five acres one hundred and ten perches and the allowance proportioned at six per cent for roads &c. Situate in Fairfield township in the County of Westmoreland. Surveyed May 3^d 1826

S. L. Carpenter D. S.

Gabriel Hiester Esquire

Surveyor General of Penn^a

I believe the above to be correct

John Gay. D. S.

IN TESTIMONY that the above is a copy of the original remaining on file in the Department of Internal Affairs of Pennsylvania, made conformably to an Act of Assembly approved the 16th day of February, 1833, I have hereunto set my Hand and caused the Seal of said Department to be affixed at Harrisburg, this twentieth day of May 1905

[Signature]
Secretary of Internal Affairs.